

INSTALLATION INSTRUCTIONS



IMPORTANT

Before opening your Lights.com table lamp, please make sure that you carefully read through these instruction sheets.

NOTE: The important safeguards and instructions that appear in this manual are not meant to cover all possible conditions and situations that may occur. It must be understood that common sense, caution and care, are factors that can't be built into any product. This approach must be used by the person(s) caring for and operating the table lamp.

GENERAL INFORMATION

All electrical connections must be in accordance with all ordinances, local and national electrical codes.

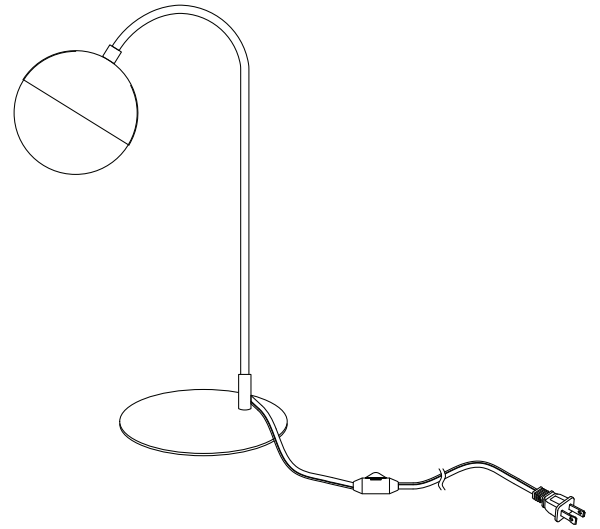

COLLECTION

Powell

APPLICATION

Table Lamp

MODEL NO.

LC004008

LC004009

WHAT WE PROVIDE

- Mounting Hardware
- 1x G9 LED 5W
- Socket & Cord + Dimmer Set

STEP BY STEP INSTRUCTIONS

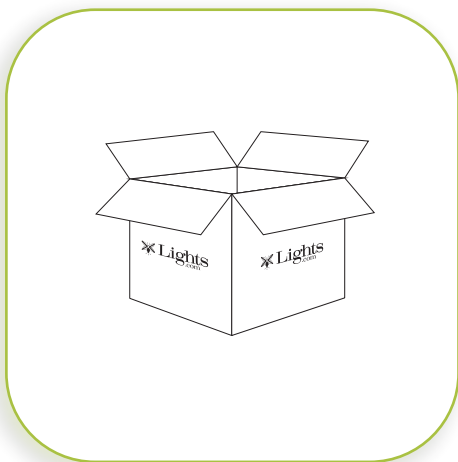

1

UNPACK YOUR FIXTURE



2

INSTALL THE BULB

Insert the bulb.

MAXIMUM WATTAGE 40W.

DO NOT EXCEED THE WATTAGE AS STATED ON THE WARNING LABEL.

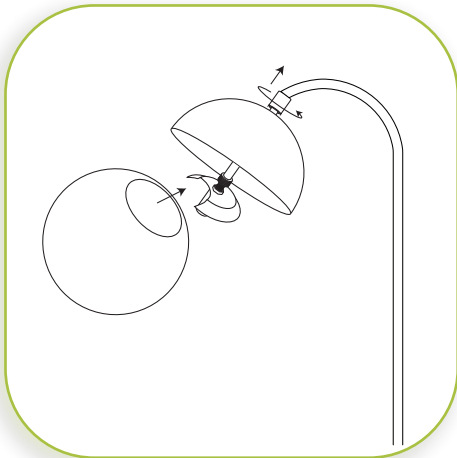

3

INSTALL GLASS

Unscrew decorative nut, above the metal shade, counter-clockwise. Slide metal shade along with the decorative nut up the rod. Insert glass onto one side of glass holder (metal bracket above socket). Next, shift angle of glass shade to insert the opposite side of glass into the holder.

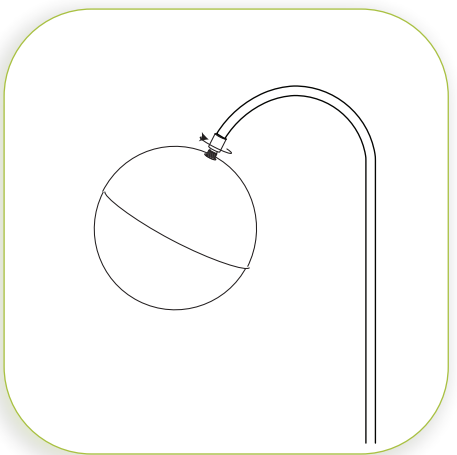

4

SECURE METAL SHADE

Gently place metal shade over glass. Thread decorative nut on clockwise. Hand tighten to secure.

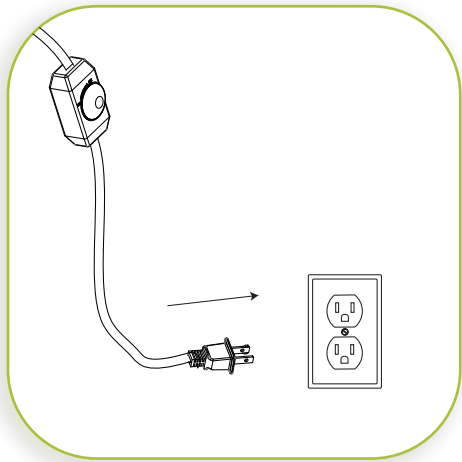

5

PLUG IN FIXTURE