

## INSTALLATION INSTRUCTIONS



### IMPORTANT

Before opening your LampLust Taper Candles with Removeable Base, please make sure that you carefully read through these instruction sheets.

**NOTE:** The important safeguards and instructions that appear in this manual are not meant to cover all possible conditions and situations that may occur. It must be understood that common sense, caution and care are factors that can't be built into any product. This approach must be used by the person(s) caring for and operating the candles.

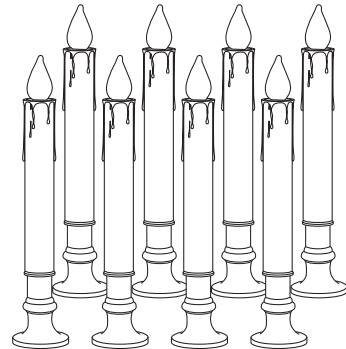

### GENERAL INFORMATION

Battery installation should only be performed by an adult. Only batteries of the same or equivalent type as recommended should be used. Battery leakage can cause corrosion and damage to this product so please remove non-functioning batteries immediately. Remove the batteries from product during long periods of non-use.

DO NOT DISPOSE OF IN FIRE. Please dispose at your local recycling facility.

### MODEL NO.

LC003448

LC003449

### WHAT WE PROVIDE

- Eight White Taper Candles with Removable Bases
- 16 AA Batteries (2 Per Candle)
- 6 Button Remote Control
- 8 Suction Cup Holders

### STEP BY STEP INSTRUCTIONS

Before turning your candles on, remove the battery tab from the battery compartment (located on top of the candle underneath the flame), thereby activating the batteries.

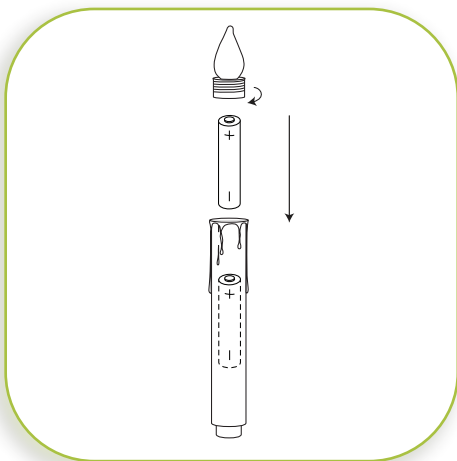

# 1

### BATTERY INSTALLATION

The candles work with 2 x AA batteries (included). To locate the battery compartment unscrew the flame from the top of the candle (counter clockwise). Batteries should be inserted with the correct polarity as indicated (+/-) and battery compartments secured before use.

## INSTALLATION INSTRUCTIONS

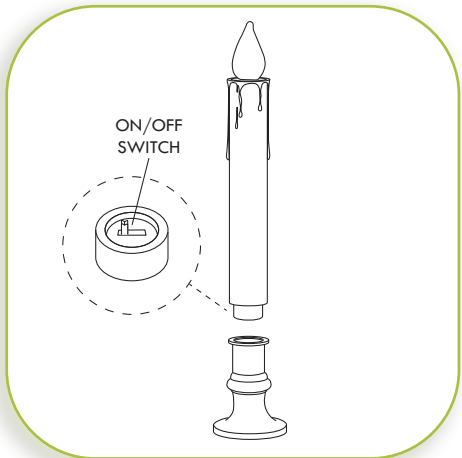

# 2

### ON/OFF

The ON/OFF switch is located on the bottom of the taper. To turn the candle ON/OFF remove the candle from the base and use this switch. Once the candle is turned to the "ON" position, it can be controlled using the remote, until it is manually turned to "OFF".



# 3

### SUCTION CUP HOLDER (OPTIONAL)

Carefully, clip the suction cup holder onto the candle base as shown in the diagram. To ensure a firm bond, surfaces should be totally free of dirt and soap film before attaching the suction cup. Rinse the inside of the suction cup under warm water then shake off the excess water. Press the suction cup firmly in place, making sure there are no air bubbles between the cup and the mounting surface.

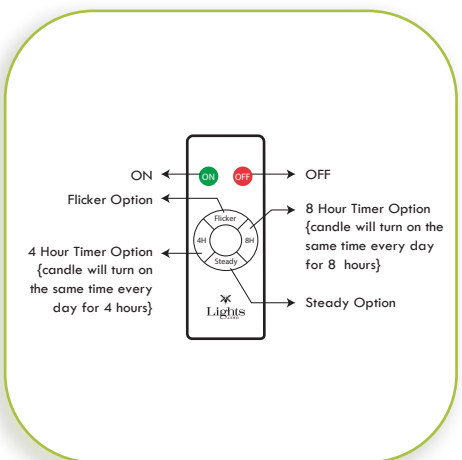

# 4

### REMOTE FUNCTIONS

The candle switch must be turned to "ON" in order for the remote control to function.