

INSTRUCTIONS



IMPORTANT

Before using your Infinity Wick 7" Taper Candles, please make sure that you carefully read through these instruction sheets.

NOTE: The important safeguards and instructions that appear in this manual are not meant to cover all possible conditions and situations that may occur. It must be understood that common sense, caution and care are factors that can't be built into any product. This approach must be used by the person(s) caring for and operating the candles.

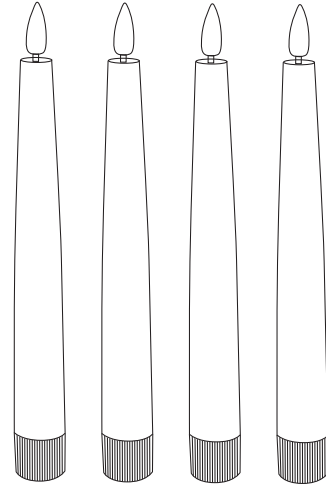

GENERAL INFORMATION

Battery installation should only be performed by an adult. Only batteries of the same or equivalent type as recommended should be used. Battery leakage can cause corrosion and damage to this product so please remove non-functioning batteries immediately. Remove the batteries from product during long periods of non-use.

DO NOT DISPOSE OF IN FIRE. Please dispose at your local recycling facility.

STEP BY STEP INSTRUCTIONS

Before turning on your candles, remove the plastic from around the batteries and insert them into the the battery compartment.

MODEL NO.

LC004928

LC004929

WHAT WE PROVIDE

- 4 x Infinity Wick 7" Taper Candles
- 4 x AAA Batteries (1 Per Candle)
- 6 Button Remote Control

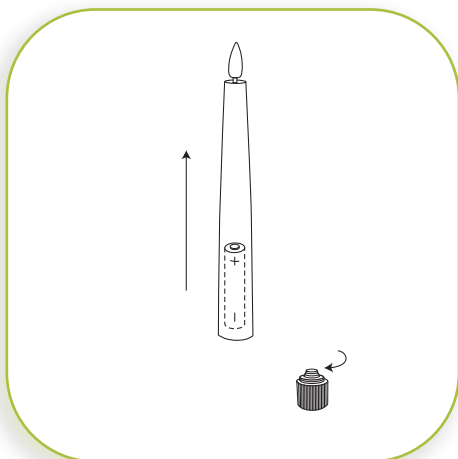

1

BATTERY INSTALLATION

Each candle works with 1 x AAA battery (included). The battery compartment is located on the bottom of the candles. To open the battery compartment, turn the base of the candle counter-clockwise. Batteries should be inserted with the correct polarity as indicated (+/-) and battery compartments secured before use.

INSTRUCTIONS

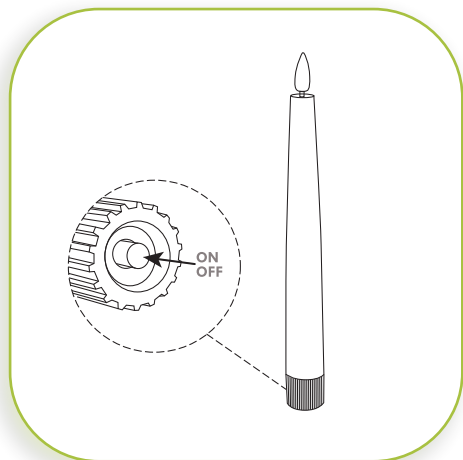

2

ON/OFF

Push the button on the base of the candle to switch on or off. To maximize battery life, switch candle off during long periods of non-use.

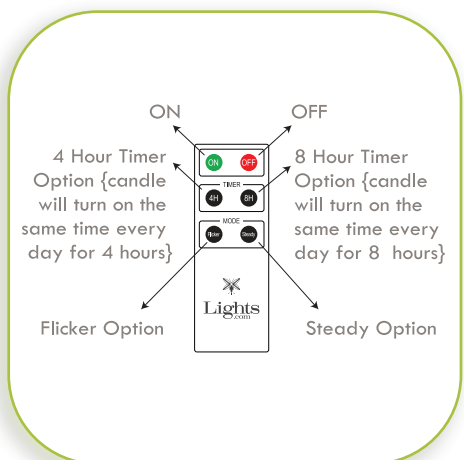

3

REMOTE FUNCTIONS

The candle must be manually turned on in order for the remote control to function.

! WARNING

- **INGESTION HAZARD:** This product contains a button cell or coin battery.
- **DEATH** or serious injury can occur if ingested.
- A swallowed button cell or coin battery can cause **INTERNAL CHEMICAL BURNS** in as little as **2 HOURS**.
- Keep new and used batteries **OUT OF REACH OF CHILDREN**.
- **SEEK IMMEDIATE MEDICAL ATTENTION** if a battery is suspected to be swallowed or inserted inside any part of or body.

