

INSTRUCTIONS



IMPORTANT

Before using your Cooper Outdoor Lantern, please make sure that you carefully read through these instruction sheets.

Battery installation should only be performed by an adult. Only batteries of the same or equivalent type as recommended should be used. Battery leakage can cause corrosion and damage to this product so please remove non-functioning batteries immediately. Remove the batteries from product during long periods of non-use.

DO NOT DISPOSE OF IN FIRE. Please dispose at your local recycling facility.

NOTE: The important safeguards and instructions that appear in this manual are not meant to cover all possible conditions and situations that may occur. It must be understood that common sense, caution and care are factors that can't be built into any product. This approach must be used by the person(s) caring for and operating the lanterns.

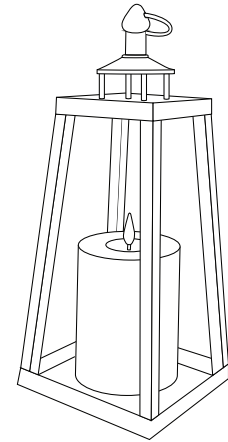

MODEL NO.

- LC005101
- LC005102

WHAT WE PROVIDE

- 1 x Cooper Outdoor Lantern
- 2 x C Batteries

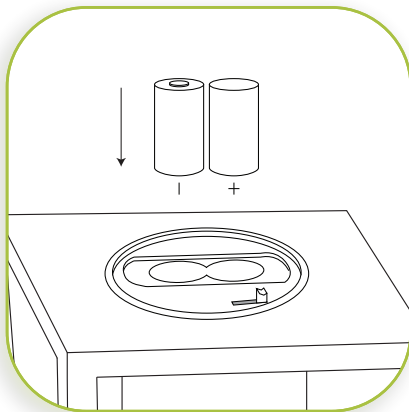

1

BATTERY INSTALLATION

The lantern works with 2 x C batteries. The battery compartment is located on the bottom of the lanterns. To install new batteries, remove the panel on the bottom. Batteries should be inserted with the correct polarity as indicated (+/-) and battery compartments secured before use.

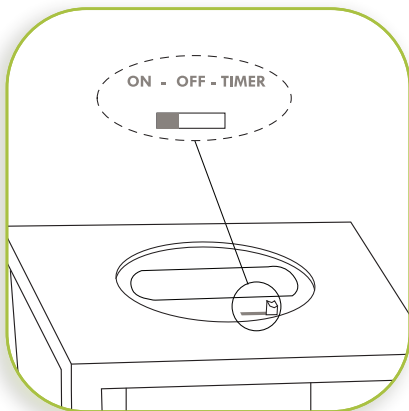

2

ON/OFF/TIMER SWITCH

The ON/OFF/TIMER switch is located on the bottom of the lantern, next to the battery compartment. Utilize this switch to turn the lantern on, off, or to set the optional 6-hour timer. Once the timer is set, it will turn on at the same time every day for 6 hours. This will repeat until the lantern is manually turned off, or until the batteries need to be replaced.