

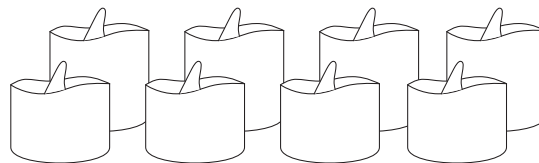

**IMPORTANT**

Before operating your LampLust InfinityWick Collection Ivory Votive Candles, please make sure that you carefully read through these instruction sheets.

**NOTE:** The important safeguards and instructions that appear in this manual are not meant to cover all possible conditions and situations that may occur. It must be understood that common sense, caution and care are factors that can't be built into any product. This approach must be used by the person(s) caring for and operating the candles.



**GENERAL INFORMATION**

Battery installation should only be performed by an adult. Only batteries of the same or equivalent type as recommended should be used. Battery leakage can cause corrosion and damage to this product so please remove non-functioning batteries immediately. Remove the batteries from product during long periods of non-use.

DO NOT DISPOSE OF IN FIRE. Please dispose at your local recycling facility.

**WHAT WE PROVIDE**

- Eight InfinityWick Collection Ivory Votive Candles (4 - 2"x 3", 4 - 2"x 4")
- 8 CR2032 MAX Batteries (1 Per Votive)
- 6 Button Remote Control

**STEP BY STEP INSTRUCTIONS**

Before turning on your tealights, remove the battery tab from the battery compartment, (located on the bottom of the tealight) thereby activating the battery.

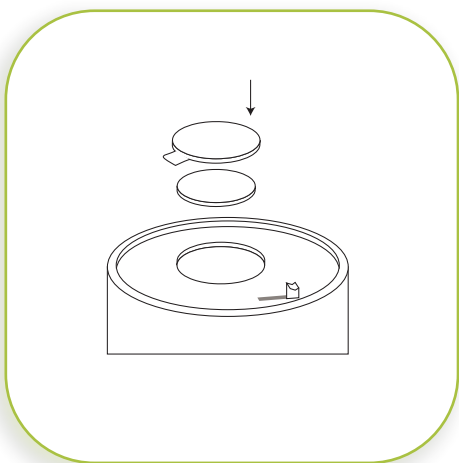

1

**BATTERY INSTALLATION**

Each tealight works with 1 x CR2032 MAX or CR2032 battery (included). The battery compartment is located on the bottom of the tealight. Batteries should be inserted with the correct polarity as indicated (+/-) and battery compartments secured before use.



# 2

## ON/OFF SWITCH

The ON/OFF switch is located on the bottom of the tealight, below the battery compartment. To turn the tealight ON/OFF use the switch located on the bottom. Once the switch is moved to the "ON" position it can be controlled using the remote, until it is manually turned to "OFF".

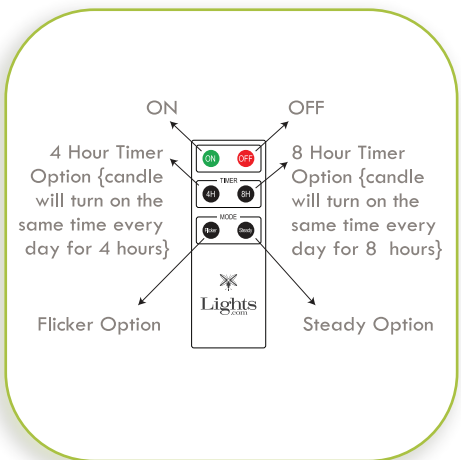

# 3

## REMOTE FUNCTIONS

The tealight switch must be turned on in order for the remote control to function.