

## INSTALLATION INSTRUCTIONS



### IMPORTANT

Before operating your Lights.com table lamp, please make sure that you carefully read through these instruction sheets. Consider having your fixture installed by a qualified licensed electrician.

**NOTE:** The important safeguards and instructions that appear in this manual are not meant to cover all possible conditions and situations that may occur. It must be understood that common sense, caution and care, are factors that can't be built into any product. This approach must be used by the person(s) caring for and operating the fixture.

### GENERAL INFORMATION

All electrical connections must be in accordance with all ordinances, local and national electrical codes.

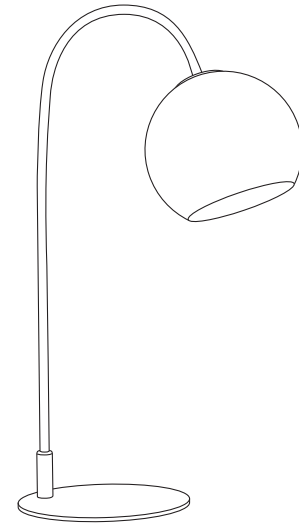

### COLLECTION

Celeste  
with Clear Globe

### APPLICATION

Table Lamp

### MODEL NO.

LC004256

LC004257

### WHAT WE PROVIDE

- Lamp
- Dimmer Switch

### WHAT YOU NEED

- 1x 60W E26 Bulb

### STEP BY STEP INSTRUCTIONS

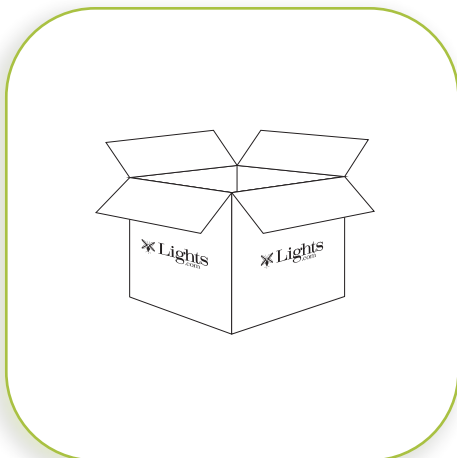

# 1

## UNPACK YOUR FIXTURE

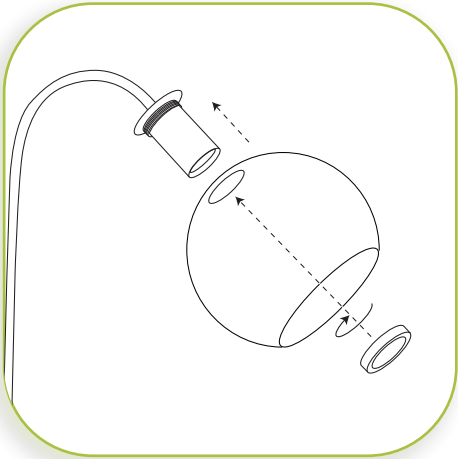

# 2

## **INSTALL GLASS SHADE**

Remove the socket ring from the socket.  
Install glass shade onto the socket and secure  
in place with socket ring.

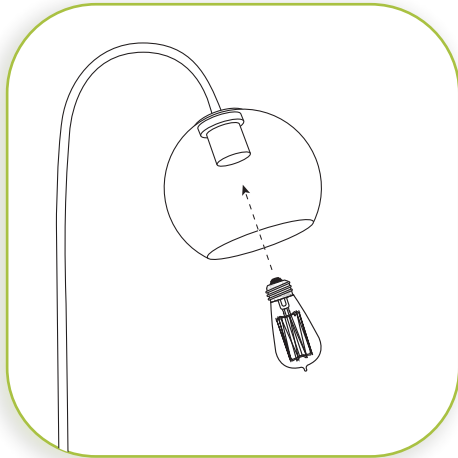

# 3

## **INSTALL THE BULB**

Insert the bulb.  
MAXIMUM WATTAGE 60W.  
DO NOT EXCEED THE WATTAGE AS STATED ON  
THE WARNING LABEL.

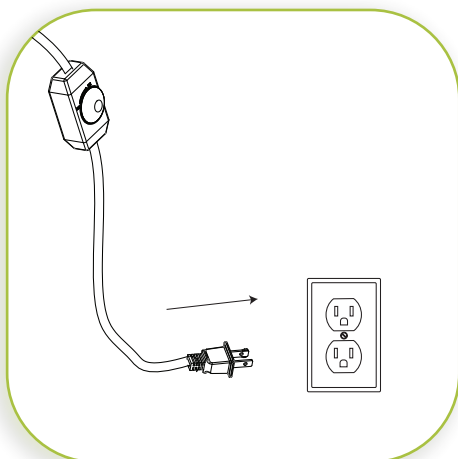

# 4

## **PLUG IN FIXTURE**

Lamp is equipped with an in-line dimmer switch.  
Not only does this allow you to create a great  
ambiance, it allows for energy savings and extends  
the life of the bulb.

## **DIMMER NOTE**