

Installation Instructions



BROOKLYN

Before assembling your *Bulb CO.* fixture, please make sure that you carefully read through these instruction sheets. Consider having your fixture installed by a qualified licensed electrician.

NOTE: The important safeguards and instructions that appear in this manual are not meant to cover all possible conditions and situations that may occur. It must be understood that common sense, caution and care, are factors that can't be built into any product. These factors must be supplied by the person(s) caring for and operating the fixture.

GENERAL INFORMATION

All electrical connections must be in accordance with all ordinances, local and national electrical codes. These fixtures are intended for mounting to a standard 4" x 2 1/2" metal octagon outlet box. The box must be directly supported by the building structure and U.L. Recognized.

STEP BY STEP INSTRUCTIONS

Before starting your installation disconnect the power by turning off the circuit breaker or by removing the fuse at the fuse box. Just turning the light off at the light switch is not sufficient to prevent electrical shock.

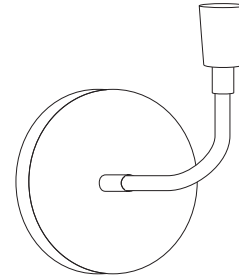

COLLECTION

Celeste

APPLICATION

Wall Sconce

MODEL NO.

LC003542

LC003543

LC003544

LC003545

WHAT WE PROVIDE

- Mounting & Wiring Hardware

WHAT YOU NEED

- Phillips Screwdriver
- Wire Cutters
- Wiring Supplies As Specified
By Electrical Code
- 1 X 60w E26 Bulb



1

UNPACK FIXTURE

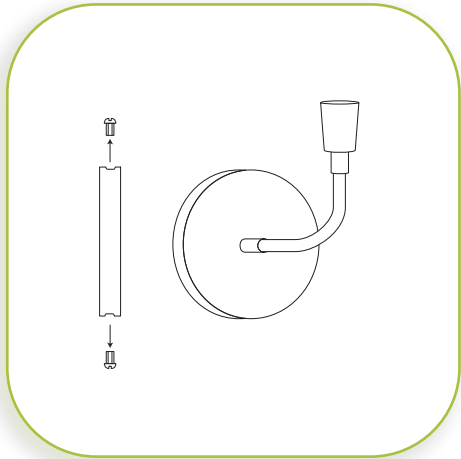

2

PREPARE FIXTURE AND MOUNTING PLATE

Remove the mounting plate by unscrewing the side screws from the backplate.

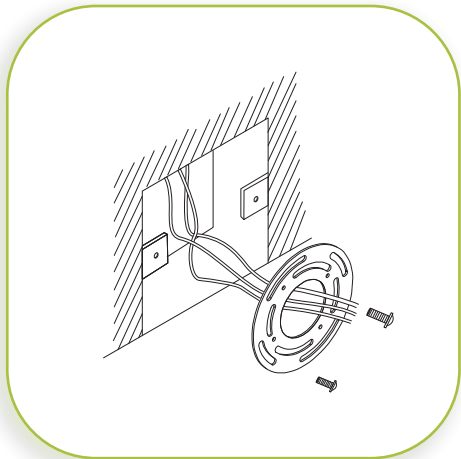

3

INSTALL THE MOUNTING PLATE

If there is an existing fixture, remove it. Expose the supply wires from the J-Box. Insert supply wires through the mounting plate. Secure mounting plate using two Phillips head screws provided. Tighten to secure.

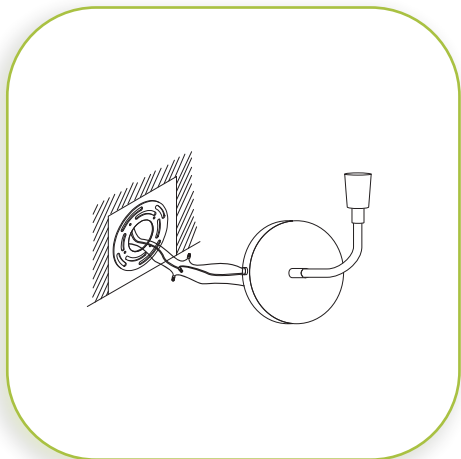

4

CONNECT WIRES

Connect the BLACK fixture wire to the BLACK supply wire and the WHITE fixture wire to the WHITE supply wire. Connect the fixture ground wire to the J-BOX ground wire. Secure all connections with the supplied wire nuts and electrical tape (not supplied).

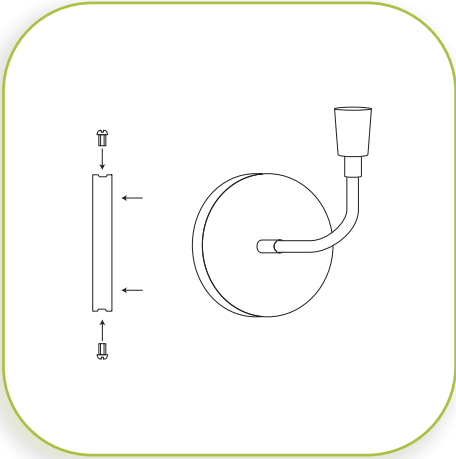

5

CONNECT FIXTURE TO WALL

Place backplate over mounting plate. Slightly adjust to align two holes. Secure using supplied screws.

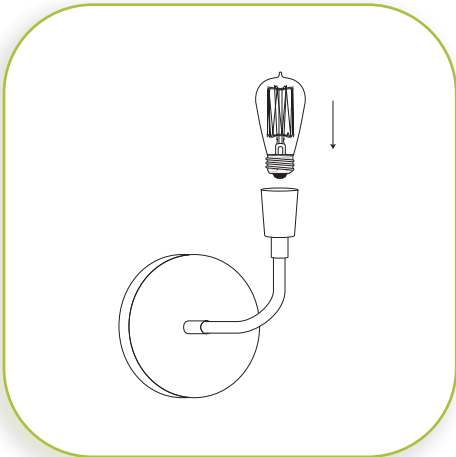

6

INSTALL THE BULB

Insert the bulb.

MAXIMUM WATTAGE 60W.

DO NOT EXCEED THE WATTAGE AS STATED ON THE WARNING LABEL.

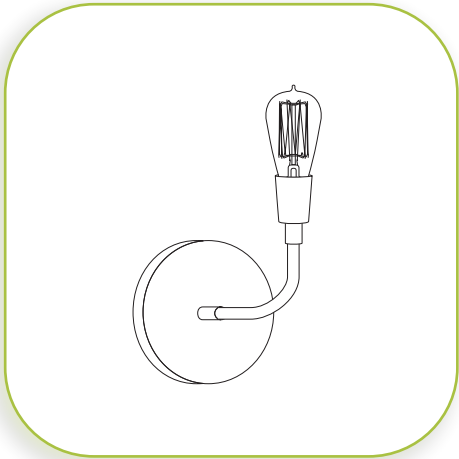

7

RESTORE THE ELECTRICITY AND CHECK THE OPERATION OF YOUR NEW FIXTURE



DIMMER NOTE

For the best lighting experience, we recommend using a dimmer. Not only does this allow you to create a great ambiance, it allows for energy savings and extends the life of the bulbs.